



## Water Conservation Services

513 De La Vina St., Santa Barbara, CA 93101 (805) 963 5511 (805) 957 1740 FAX

### About Us

Water Conservation Services, a division of SecureCoin, Inc., has been the leader in metered shower systems and timed-vend solutions for over ten years. In that time, WCS CashMaster and TouchMaster Metering Systems have helped Federal, state and private facilities across the U.S. save up to 70% in water and energy use in campground showers facilities, sports lighting systems, marina services, amusements and many other applications.

WCS began by working closely with the California Department of Parks and Recreation in the State's request for a metered shower program to help reduce water and energy use in State Campground facilities. Along with manufacturing and sales of metered shower systems, WCS installed, serviced and maintained metered shower systems in California State Park Campgrounds for 10 years. Through hands-on experience, WCS continued to develop and improve upon the safest and most reliable metered shower designs. WCS Metered Shower Systems have always utilized the most durable construction and most reliable components to save our customers *and us* costly maintenance time.

Since its inception, WCS has continuously added to the list of Federal and State agencies specifying CashMaster Metered Shower Systems as part of their conservation programs. Today, WCS' customers include the US Army Corps of Engineers, the US Forest Service, California State Parks, Colorado State Parks, Washington State Parks, Oklahoma State Parks and many others. In addition, WCS has provided the same conservation solutions to many private recreation facilities looking to offset costs and improve services.

Today's line of WCS Metering Controls are the most advanced and reliable available. All WCS systems utilize solid-state digital electronics and heavy-duty construction. WCS is the only manufacturer whose shower controls are approved and listed by Underwriter Laboratories (UL), the leader in U.S. product safety and certification. WCS has gone to this extra effort and expense to assure its customers that WCS products are safe and reliable.

WCS looks forward to helping more agencies and private facilities reduce costs and meet government mandates for water and energy conservation. WCS is a complete resource to help guide customers in designing and planning a water and energy conservation program. WCS has systems and solutions to fit the needs and budget of any size facility from the largest State Beach Campground in California to a small family-run marina and RV park in Maine.



# CashMaster Coin-Operated Shower System

CashMaster Metered Shower Systems from WCS are the quickest and most cost-effective way to make significant reductions to your water and energy bills. Many of our systems have brought our customers water and energy savings of up to 70% and paid for themselves in a matter of months. WCS has worked closely with government park agencies over the last 10 years to build a system that is rugged enough for the busiest campgrounds in the country. Whether you operate a small private campground in Maine with just a few showers or a State campground on the California Coast, we have a system designed to suit your needs and budget.



**CashMaster Controller Module**  
UL Listed

## WCS CashMaster

### Complete System Includes:

- CashMaster Controller Module
- Stainless Steel MeterBoxes
- High-Security Lock and Key Sets
- Reliable, Accurate Coin Acceptors
- Industrial Duty Solenoid Valves
- MeterBox Label Sets



**Vandal-Resistant MeterBoxes**  
12-gauge Stainless Steel  
3 models to suite your building requirements

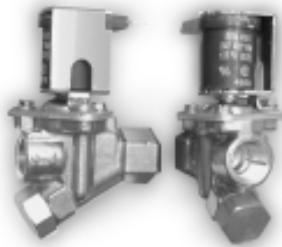

**Industrial Duty Solenoid Valves**



**Reliable, Accurate Coin Acceptors**  
3 models to suite your security and coin requirements



**High-Security Lock and Key Sets**

## WCS CashMaster System 1, 2 and 3 Standard Components

### WCS CashMaster System 1

- CMCM-221 Controller, UL Listed
- CMMB-121 Surface Mount Meterbox
- CMCA-121 Mechanical Coin Acceptor
- CMSV-221 Solenoid Valve, UL Listed
- CMLS-MLS, HLS Camlock and Key Set
- Label Set per customer specification

### WCS CashMaster System 2

- CMCM-221 Controller, UL Listed
- CMMB-121 Surface Mount Meterbox
- EP-2 Electronic Coin Acceptor
- CMSV-221 Solenoid Valve, UL Listed
- CMLS-MLS, HLS Camlock and Key Set
- Label Set per customer specification

### WCS CashMaster System 3

- CMCM-321 Controller, Audit Capabilities, UL Listed
- CMMB-121 Surface Mount Meterbox
- EP-2 Electronic Coin Acceptor
- CMSV-221 Solenoid Valve, UL Listed
- CMLS-MLS, HLS Camlock and Key Set
- Label Set per customer specification

### Optional Components

- CMMB-221 Flush Mount Rear Access Meterbox
- CMMB-321 Flush Mount Front Access Meterbox
- CMCA-321 Electronic Programmable Multi-Coin Acceptor (Avail. with Sys 2 and Sys 3 only)

All WCS Systems are Underwriters Laboratories Listed, allowing their legal installation in public and private facilities where uniform building codes and OSHA workplace safety standards are enforced. U.L. Listing provides assurance that your facility users and maintenance staff are safe, and you are protected from liability. All WCS Systems are also Class II wiring and ADA (Americans with Disabilities Act) compliant when properly installed.



## Water Conservation Services

a division of SecureCoin, Inc.  
513 De La Vina St., Santa Barbara, CA 93101  
Tel (888) 872 4975 • Itl. (805) 963 5511 • Fax (805) 957 1740  
[www.watercon.com](http://www.watercon.com) • [info@watercon.com](mailto:info@watercon.com)



## CMCM-221, 321 CashMaster System Controller

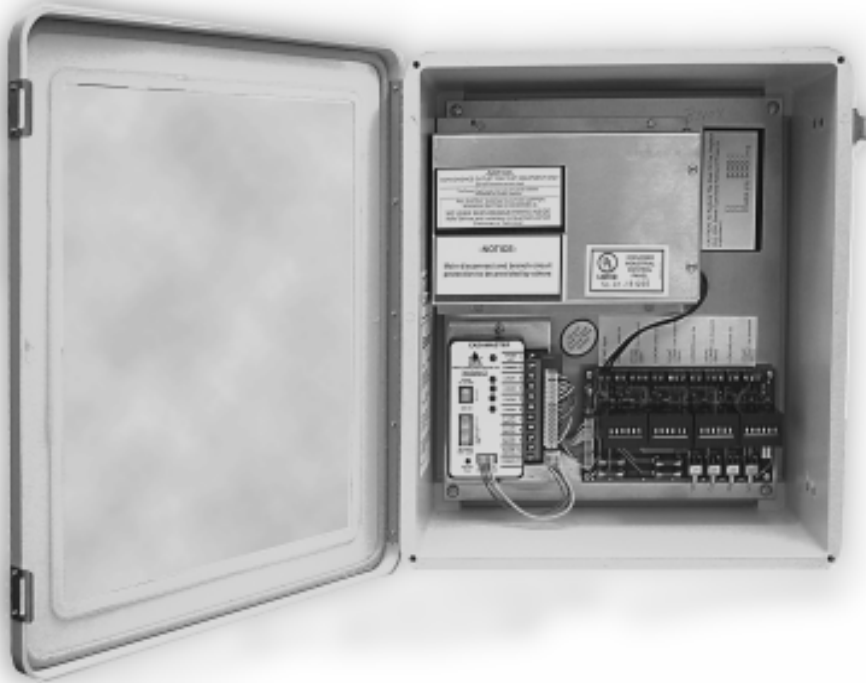

### CMCM-221, 321

**The CashMaster Controller Module** is an industrial grade, purpose-built, UL Listed shower timing module. WCS is the only manufacturer of UL Listed metered shower controls - your assurance that our systems are safe for your customers and employees. Each controller can operate up to four showers. Controllers are provided with each CashMaster system according to the customer's facility requirements.

#### Standard Features:

- Environmentally-resistant enclosure box, high humidity and temp. rated
- CashMaster 4-in-1 Timer programs easily for number of coins to start and time per coin
- Integrated Ground-Fault Circuit Interrupter (GFCI)
- 110-24VAC Transformer
- Solid-state circuit board with current protection fuses
- Convenient status indicator LED lights
- Manual override switches for easy testing and maintenance
- Accounting features/non-resettable counters (System 3, only)
- Complete Electrical Control Panel UL Listed



## Water Conservation Services

a division of SecureCoin, Inc.  
513 De La Vina St., Santa Barbara, CA 93101  
Tel (888) 872 4975 • Itl. (805) 963 5511 • Fax (805) 957 1740  
[www.watercon.com](http://www.watercon.com) • [info@watercon.com](mailto:info@watercon.com)



## CMMB-121, 221, 321 MeterBox Options



CashMaster MeterBoxes by WCS are manufactured of super heavy duty 12-gauge 304 stainless steel. Individual parts and cutouts are laser cut for close tolerance. Precise fit and full seam welding (not spot or tack welded) results in quality appearance and superior vandal resistance. Large reinforced cash vault holds 500 coins allowing more time between collections than smaller boxes. Each Meterbox comes with professional quality high security locksets with proprietary key codes. Locks may be keyed the same or individually as specified by customer. All CashMaster Systems include MeterBox label sets as specified by the customer. Meterboxes measure approx. 15.75" height x 4.25" width x 5.75" depth. *(Please see CashMaster Installation Manual for exact measurements and installation instructions).*



### **CMMB-121** **Surface Mount Meterbox**

- Comes standard with all CashMaster Systems
- Bolts to wall surface
- Ideal for simple retrofit of existing shower buildings

ref. WCS doc. 700003r2 for specifications



### **CMMB-221** **Flush Mount Rear Access Meterbox**

- Available as an option with all CashMaster Systems
- Installs flush to wall surface
- Coin vault and coin acceptor are accessed from rear
- Coins can be collected from secure room behind showers
- Shower building can remain open during coin collections

ref. WCS doc. 700002r2 for specifications



### **CMMB-321** **Flush Mount Front Access Meterbox**

- Available as an option with all CashMaster Systems
- Installs flush to wall surface
- Coin vault and coin acceptor are accessed from front
- Ideal for facilities with limited space and no rear access

ref. WCS doc. 700001r2 for specifications

## **Water Conservation Services**

a division of SecureCoin, Inc.  
513 De La Vina St., Santa Barbara, CA 93101  
Tel (888) 872 4975 • Itl. (805) 963 5511 • Fax (805) 957 1740  
[www.watercon.com](http://www.watercon.com) • [info@watercon.com](mailto:info@watercon.com)



## CMCA-121, EP2, EP5 Coin Acceptor Options

CashMaster Coin Operated shower systems feature the most durable and reliable coin acceptors available. All WCS Coin Acceptors are made of high-impact, non-corrosive plastic and stainless steel. All electronics and sensors are waterproof to allow for reliable service in wet environments. Several options are available to allow for multiple coins or tokens.

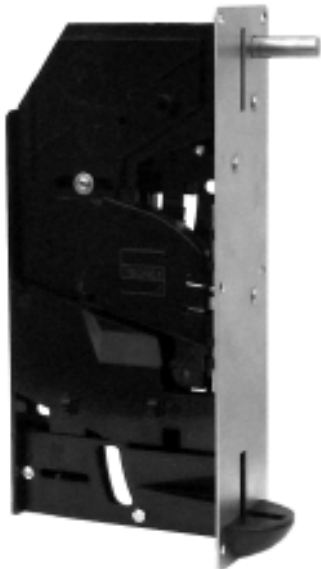

### CMCA-121 Mechanical Coin/Token Acceptor

- Comes standard with CashMaster System 1
  - Reliable mechanical evaluation of each coin
  - Manual coin return easily clears coin path, simplifying maintenance
  - Low voltage operation (24VAC)
- ref. WCS doc. 300001r4 for specifications



### EP2 Electronic Coin Acceptor

- Comes standard with CashMaster System 2 and 3
  - Precise electronic coin identification, slug rejection
  - Accepts US quarter and dollar coin
  - Waterproof construction
  - Low voltage operation (24VAC)
- ref WCS doc. 300002r5 for specifications



### EP5 Electronic Programmable Multi-Coin Acceptor

- Available as an option with CashMaster System 2 and 3
  - Precise electronic coin identification, slug rejection
  - Pre-programmed for US quarter and dollar coin
  - Learns 3 additional tokens or coins of your choice
  - Simple touchpad programming and LED display
  - Waterproof construction
  - Low voltage operation (24VAC)
  - Will not lose program in power outage
- ref WCS doc. 300003r4 for specifications

## Water Conservation Services

a division of SecureCoin, Inc.  
513 De La Vina St., Santa Barbara, CA 93101  
Tel (888) 872 4975 • Itl. (805) 963 5511 • Fax (805) 957 1740  
[www.watercon.com](http://www.watercon.com) • [info@watercon.com](mailto:info@watercon.com)





# CMSV-221 CashMaster Solenoid Actuated Water Flow Control Valve

## Solenoid Actuated Water Flow Control Valve



- Compact construction for confined installations
- Industrial Duty: High reliability
- Low Voltage (24VAC)
- Built-in sediment strainer
- Stainless steel seat
- Brass Valve Body - CMSV-221
- Celcon Valve Body - CMSV-121
- Standard electrical installation
- Molded, waterproof coil
- UL Listed
- Rebuildable
- Class II wiring compliant\*

### Operates with:

Controllers:  
CMCM -221, 321

\*when properly installed using CM SYSTEM 1, 2, or 3 components

## Description

The CMSV-221 is used in the CASHMASTER SERIES COIN-OPERATED SHOWER SYSTEMS to control the flow of water from source to shower head. Depending on plumbing layout, it may be installed before or after mixing valves, on either or both the hot and cold water supplies. In tempered, recirculating water supplies a single solenoid valve is required and may replace manual valves completely in a valveless automated system.

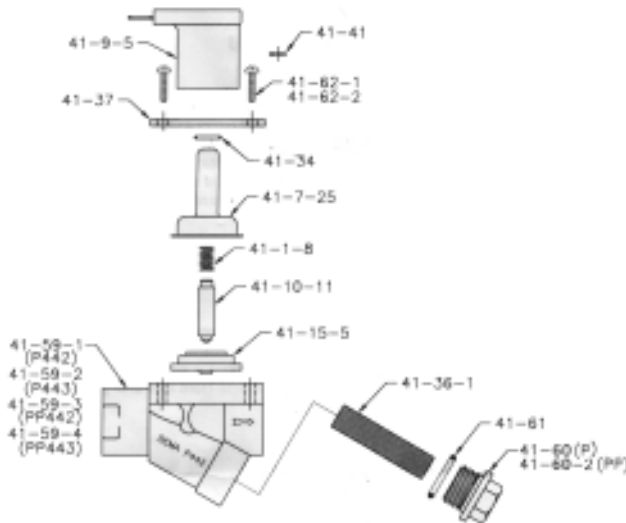

PART NO.	DESCRIPTION
41-1-8	KICK OFF SPRING
41-7-25	ENCLOSING TUBE (STAINLESS)
41-9-5	SOLENOID COIL
41-10-11	PLUNGER
41-15-5	DIAPHRAM
41-34	SPACER RING
41-36-1	STRAINER SCREEN
41-37	FLANGE
41-41	NYLON WASHER
41-59-1	VALVE BODY (P442)
41-59-2	VALVE BODY (P 443)
41-59-3	VALVE BODY (PP 442)
41-59-4	VALVE BODY (PP 443)
41-60	SCREEN CAP (P442-P443)
41-61	SCREEN CAP (PP442-PP443)
41-62-1	SCREW #8-18 X 1/2 LG. (2 REQ'D.)
41-62-2	SCREW #8-18 X 3/8 LG. (1 REQ'D.)

## Component Specifications

- Pipe Size N.P.T 3/8"\*
- Conduit Attachment 3/8"
- Energized Position: Open
- Valve Body: Brass
- Description: Diaphragm Type, Remote Actuation
- \*1/2" adapters available

## Operating Specifications

- 24VAC/50-60Hz
- Ambient Temp. Max: 170F
- Water Temp. Max: 250F
- Max Operating Pressure: 125psi
- Load: 10VA

## Water Conservation Services

a division of SecureCoin, Inc.  
51 Santa Felicia Drive, Goleta, CA 93117  
Tel (888) 872 4975 • Itl. (805) 571 6900 • Fax (805) 571 3513  
[www.watercon.com](http://www.watercon.com) • [info@watercon.com](mailto:info@watercon.com)



# Hydrotek Automatic Faucets and Flush Valves

- **ADA Compliant.** Meets all barrier free codes.
- **Conserves** water and energy.
- **Easily installed** in new or retrofit applications.
- **Competitively priced** for today's commercial market.
- **Proven** Hydrotek craftsmanship and reliability.
- **Promotes** cleanliness and hygiene.



2603C Series



3000C Series



1000C Series



9000 Series  
Automatic  
Shower



HB8RFKC



4000C Series



6000C Series



6700C Series



HB-8000C Series



H-8000C Series

## Water Conservation Services

a division of SecureCoin, Inc.

513 De La Vina St.

Santa Barbara, CA 93101

Tel (888) 872 4975 • Intl. (805) 963 5511 • Fax (805) 957-1740

[www.watercon.com](http://www.watercon.com) • [info@watercon.com](mailto:info@watercon.com)



## AC1002, AC1005 Bill Changers

### Description

The AC1002 and AC1005 high-security bill to coin changer machines are an excellent addition to any facility with coin-operated showers or vending. A coin changer can pay for its self in a matter of months through labor-cost savings and improved security. AC1002 and AC1005 changers are constructed of heavy-gauge steel and include reliable bill validators and coin dispensors.

### AC1002 Front-Load Changer



### Dispensing Capacities

Can dispense one of the following:

- Dollar Coins (2,200)
- Quarters (2,800)
- Tokens (2,800) 20mm-30mm

Validator Acceptance: \$1, \$2, \$5, \$10, \$20

Validator Capacity: 500 Bills

Token Bonus Payout: 1 Option Available

### Available Options

- Security Alarm
- Audit Printer
- Dollar Coin Acceptor
- Optional Capacity (stacker): 650 Bills

### Warranty

1 Year

2 Years on Validator

**UL Listed**

### AC1005 Rear-Load Changer



## Water Conservation Services

a division of SecureCoin, Inc.

51 Santa Felicia Drive, Goleta, CA 93117

Tel (888) 872 4975 • Int. (805) 571 6900 • Fax (805) 571 3513

[www.watercon.com](http://www.watercon.com) • [info@watercon.com](mailto:info@watercon.com)





# Complete Water and Energy Efficiency Other Products Available from WCS

## TouchMaster System II

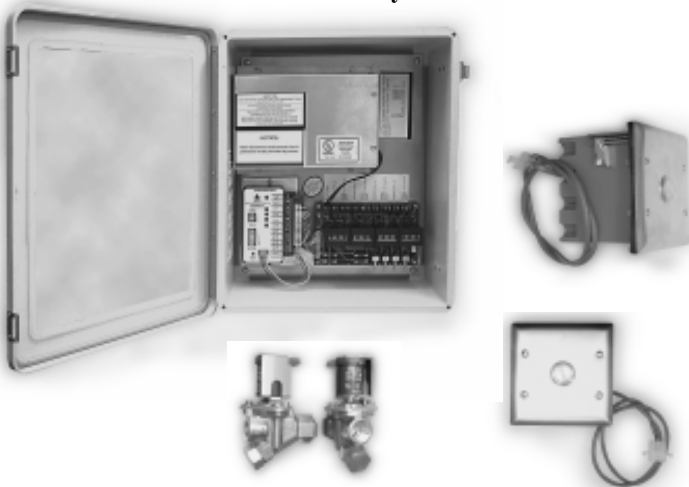

**TouchMaster II by WCS** is the Industry Leading Touch Actuated Metered Shower System. The TouchMaster offers a safe, reliable and field proven solution for facilities where water and energy saving advantages of metered showers are required but coin operation is not appropriate. The TouchMaster features the same rugged components as the CashMaster Systems, including the UL Listed Controller Module. Showers are activated by an easy-to-install, water-tight touch button module in each shower.

**AC1002 and AC 1005 Bill to Coin Changers** are an excellent addition to any facility with coin-operated showers or vending. These changers are constructed of heavy-gauge steel and come in front or rear-access models.



**AC1002 Front-Load Changer**



**AC1005 Rear-Load Changer**

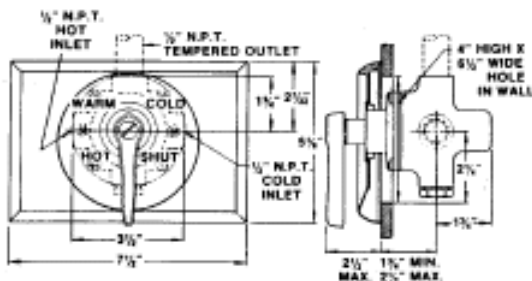

### HBL-01 Anti-Scald Mixing Valve

Attractive institutional quality mixing valve combined with the important safety features of an anti-scald mixing valve.



**HB8000C Flush Valve**



**1000C Automatic Faucet**



**H9000 Automatic Shower**

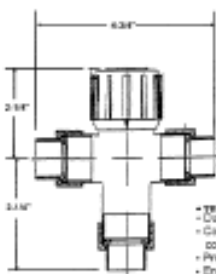

### HBL02 Anti-Scald Thermostatic Mixing Valve

Important safety measure for public shower facilities. Adjustable valve limits maximum temperature of shower water. Can be installed at water heater or at individual showers.

### Automatic Faucets and Shower Systems

Featuring advanced no-touch operation, these automatic faucets, flush valves and shower systems are an excellent way to improve conservation and hygiene in any shower/restroom facility.

## Water Conservation Services

a division of SecureCoin, Inc.  
513 De La Vina St., Santa Barbara, CA 93101  
Tel (888) 872 4975 • Itl. (805) 963 5511 • Fax (805) 957 1740  
[www.watercon.com](http://www.watercon.com) • [info@watercon.com](mailto:info@watercon.com)

		<h1>PRICE LIST</h1>	
System/ Product Pricing			
Part Number			Retail, \$US
<b>CashMaster Series</b>		<b>CASHMASTER COIN-OPERATED SHOWER SYSTEMS</b>	
CMSS-121	CashMaster System 1 complete*, per shower		\$399
CMSS-221	CashMaster System 2 complete*, per shower		\$548
CMSS-321	CashMaster System 3 complete*, per shower		\$826
CMSS-121-7A	Coin Operated Load Control System with Supertimer		\$435
CMSS-121-7B	Coin Operated Load Control with Remote Digital Display		\$645
CMSS-121-7C	Coin Operated Load Control-Digital Display Assembly		\$685
<b>CashMaster Options</b>		<b>CASHMASTER COIN-OPERATED SYSTEM UPGRADES</b>	
CMMB-221 upgrade	Flush Mount Rear Access Meterbox upgrade, per shower**		\$80
CMMB-321 upgrade	Flush Mount Front Access Meterbox upgrade, per shower**		\$110
CMCM-221 upgrade	Controller Module upgrade to Auditing Counters		\$59
CMCM-321 upgrade	Custom Programming upgrade (LMA, Lock Out, etc.)		<b>Please Call</b>
<b>TouchMaster Series</b>		<b>TOUCHMASTER TOUCH-OPERATED SYSTEMS</b>	
TMSS-121	Touchmaster Single Load System 1 with Supertimer Control		\$189
TMSS-122	Touchmaster System 2 complete*, per shower		\$289
TMSS-123	Touchmaster System 3 (Piezo Programmable Buttons) complete, per shower		\$349
<b>CardMaster Series</b>		<b>CARDMASTER SMARTCARD &amp; COIN SYSTEMS</b>	
CMWS-2000R	Wyvern Coin Operated Display Timing System		\$349
CMWS-2000PC	Wyvern Coin Operated Display Timing System (PC Interface)		\$390
CMWS-2000RD	Remote Display for PC Interface Unit Only		\$90
CMWS-2000RS	Wyvern SmartCard and Coin-Operated Display Timing System		\$399
CMWS-HHProg	Handheld SmartCard Programmer		\$420
CMWS-UniProg	Universal SmartCard PC Programmer		\$300
CMWS-SC Blank	SmartCard Blank		\$1
<b>CoinMaster Series</b>		<b>CoinMaster Traditional Timers (Wyvern)</b>	
CMWV-Token Timer (BSC)	Basic One Coin/ Non-Accumulating/ No Display		\$185
CMWV-Token Timer (BMP)	Basic/ with key override for free play		\$199
CMWV-Token Timer (ACC)	Basic Accumulating Model		\$225
CMWV-Token Timer (DMC)	Accumulating Model/ with Digital Display		\$230
CMWV-Token Timer (DMP)	Accumulating/ Digital Display/ Key Override		\$240
CMWV-Token Timer (PMC)	Accumulating/ Digital Display/ Programmable Lockout		\$249
CMWV-Token Timer (RDM)	Accumulating/ Digital Display/ Programmable Lockout/ Preprogrammed Wait Time		\$262
CMWV-Token Timer (DFC)	Accumulating/ Digital Display/ Secondary Output		\$252
Options	230VAC 50/60 Hz		\$10
Options	7kVA (30Amp)		\$10
<b>Changers</b>		<b>BILL-COIN CHANGERS</b>	
AC1002	Front-Load Bill Changer (surface-mount)		\$1399
AC1005	Rear-Load Bill Changer (flush-mount)		\$1399
MC700 Rhino	Front-Load High Security Bill Changer (surface-mount)		\$1795
MC400RL	Rear-Load High Security Bill Changer (flush-mount)		\$1885
<i>Ask about options (auditing, alarms, lock upgrades...)</i>			

<b>AUTOMATIC FAUCETS, FLUSH VALVES &amp; SHOWERS</b>		
1000C	Automatic Faucet, non-mixing (AC or Battery-Powered)	\$367
2603C	Automatic Faucet, non mixing (AC or Battery-Powered)	\$346
3000C	Automatic Faucet, mixing & manual on/off (AC or Battery)	\$532
4000C	Automatic Faucet, mixing & manual on/off (AC or Battery)	\$524
6000C	Automatic Faucet, non-mixing (AC or Battery-Powered)	\$400
6700C	Automatic Faucet, non-mixing (AC or Battery-Powered)	\$409
H-8000C	Autoflush Toilet Valve, var. sizes. (AC-Powered)	\$404
HB-8000C	Autoflush Toilet Valve, var. sizes (Battery-Powered)	\$381
HB8RFKC	Retro-fit Autoflush Toilet Valve, var. sizes (Battery-Powered)	\$308
9000C	9000C Series Automatic Shower (AC or Battery-Powered)	\$363
<b>Options</b>	<b>OTHER PRODUCTS, COMPONENTS</b>	
HBL-01	Anti-Scald Hand Mixing Valve	\$263
HBL-02	Anti-Scald Thermostatic Mixing Valve	\$145
XForm24	220/110/24VAC Stepdown Transformer (80Watts)	\$28
Decals	Cashmaster Meter Box Decal Sets	\$3.50
Brass Token	.984" 85/15 Brass Shower Token	\$0.20
Custom Token	Custom Printed Alloy Token	<b>Please call</b>
<b>REPLACEMENT COMPONENT PRICING</b>		
<b>Part Number</b>	<b>Description</b>	<b>Retail, \$US</b>
<b>METERBOXES</b>		
CMMB-121	Surface Mount Meter Box (standard on all systems)	\$174
CMMB-121-A	Surface Side-Mount Meterbox with R/L install	\$209
CMMB-221	Flush Mount Rear Access Meter Box	\$219
CMMB-321	Flush Mount Front Access Meter Box	\$249
CMMB-CV-12	Meter Box Coin Vault, 12ga. Face	\$35
CMMB-CV-10	Meter Box Coin Vault, 10ga. Face	\$42
CMMB-FP	Standard Meter Box Faceplate	\$37
CMMB-121-A-FP	Surface Side-Mount Box Faceplate	\$39
<b>COIN ACCEPTORS</b>		
CMCA-121	Manual Coin Acceptor	\$49
CMCA-121-C	Custom Coin Manual Acceptor	\$54
CMCA-121-SW	Miniature Low Torque Switch for CMCA-121	\$5
CMCA-221 (EP-2)	Electronic Coin Acceptor	\$189.50
CMCA-321 (EP-5Plus)	Programmable Electronic Coin Acceptor	\$220.50
CMCA-Euro (EP-5Plus EU)	6 Coin Programmable Euro Coin Acceptor	\$230.75
CMCA-C (EP-5Plus Cust)	5 Coin Custom Programmable Coin Acceptor	<b>Please Call</b>
FPEP2-FA	Faceplate Assembly/ EP-2/ Timer/ Faceplate	\$330
FPEP5-FA	Faceplate Assembly/ EP-5/ Timer/ Faceplate	\$345
CMQD-Connect	4-6 Circuit Polarized Nylon Pigtail Connectors	\$7.50
<b>TIMERS</b>		
EPET-121	Digital Programmable Delay Off Timer (TimerCube)	\$48.50
EPET-221	4-Channel Accumulating Timer	\$165.00
EPET-321	Programmable Supertimer/ LMA/ 1 Coin Restart	\$88.50
EPET-LED5	Dixmore Display Shelf Timer w/ remote control capabilities	\$319
FP-LED7RU	Dixmore Digital Display Timer (Bilingual) with Enclosure	\$346
FPEM-7	Parker Engineering 24VAC Accumulating Bay Timer	\$75
<b>PUSHBUTTONS</b>		
CMPB-121	Standard Vandal Resistant Pushbutton with Enclosure	\$33
CMPB-121A	Vandal Resistant Pushbutton	\$23
CMPB-221	Programmable Piezo Pushbutton Timer	\$149
<b>LOCKSETS/KEYSETS</b>		
CMLS-MSL	Medium Security (Faceplate) Lock	\$13
CMLS-HSL	High Security (Coin Vault) Lock	\$15
CMLS-HSL-PL	High Security Vault Disk Lock and core	\$20
CMLS-MSK	Medium Security (Faceplate) Key	\$4
CMLS-HSK	High Security (Coin Vault) Key	\$7

**SecureCoin Inc., Water Conservation Services Division**

513 De La Vina St., Santa Barbara, CA 93101, 888 950 9111 Intl. 805 963 5510 Fax 805 957 1740

<b>FLOW CONTROL</b>		
CMSV-221	Industrial Duty Solenoid Valve, w/Strainer, Solid Brass	\$51
CMSV-221.5	1/2" female brass adapters for CMSV-221	\$3.50
CMSV-221RB	CMSV-221 Solenoid Rebuild Kit (Spring & Diaphragm)	\$8.50
<b>CONTROLLERS</b>		
CMCM-221	Cashmaster System 1 & 2 Controller	\$459
CMCM-321	Cashmaster System 3 Controller (Auditing)	\$509

*\* Includes CMCM-221 or 321 controllers, configuration as required. Maximum, 1 controller per every 2 showers.*

*\*\*Meterbox upgrade pricing applies only at time of system purchase.*